

# Stage Impact, Large fabric walls

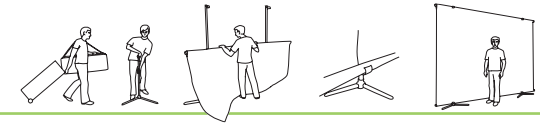

Stage 5x2, 550x225 cm

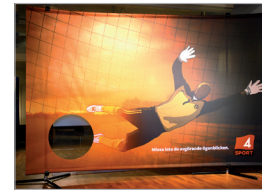

**Specifications: Stage Impact**

**CONSTRUCTION**  
Alloyed aluminium profiles

**VARIATIONS**  
Straight, Curved, S-shaped, Hanging, Trade Fair

**GRAPHIC MATERIAL**  
Textile graphics

**WIDTH**  
Variable depending on the variation  
Straight, Curved:  
from 4.4 meters  
Trade Fair: from 4x2 sqm

**HEIGHT**  
Straight, Curved, S-shaped and Trade Fair: 2.25 m - 2.5 m

**WEIGHT**  
From 15 kg

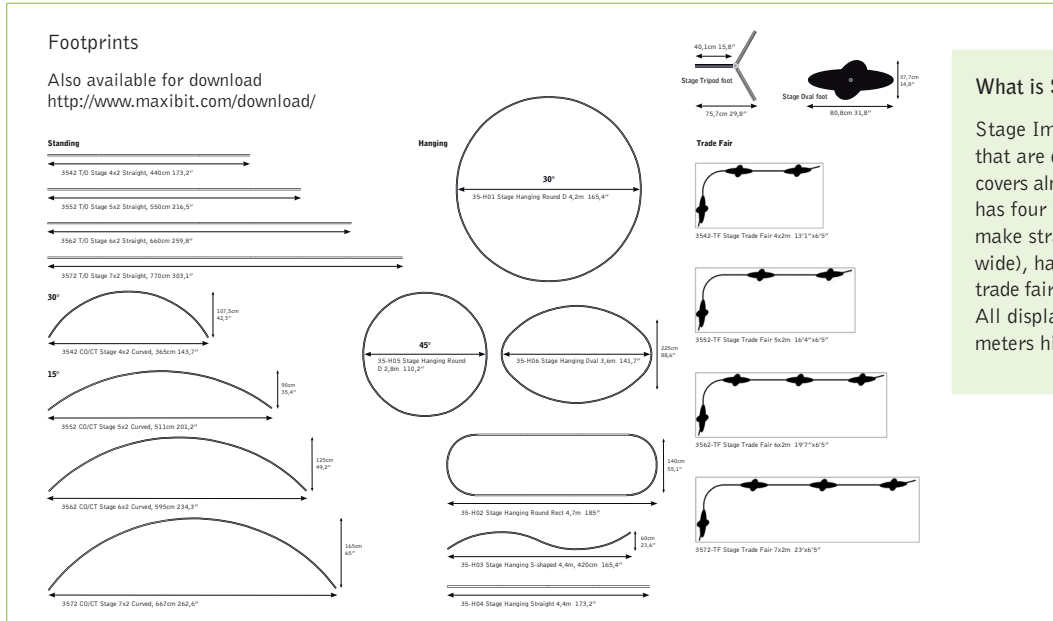

**What is Stage Impact?**

Stage Impact is a collection of Stage displays that are easy to use and quick to set up. The range covers almost every marketing need. Stage Impact has four variations. With these variations, you can make straight or curved walls (4.40 - 7.70 meters wide), hanging shapes in various formations and trade fair displays that range from 4x2 - 7x2 meters. All displays are 2.25 and can be extended to 2.50 meters high. Stage Standard is simple and elegant.

**Why choose Stage Impact:**

- Fabric is the future. Get tomorrow's technology today
- Stage is unique to Maxibit
- Stage is perfect for public spaces, congresses, company events and trade fairs
- Stage is compact to transport and gives you a huge marketing surface area



# Stage Modular, Unique stage experiences

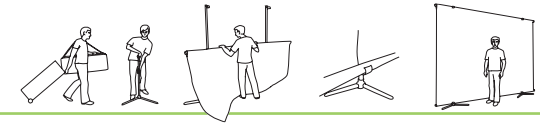

Stage 330x350 cm

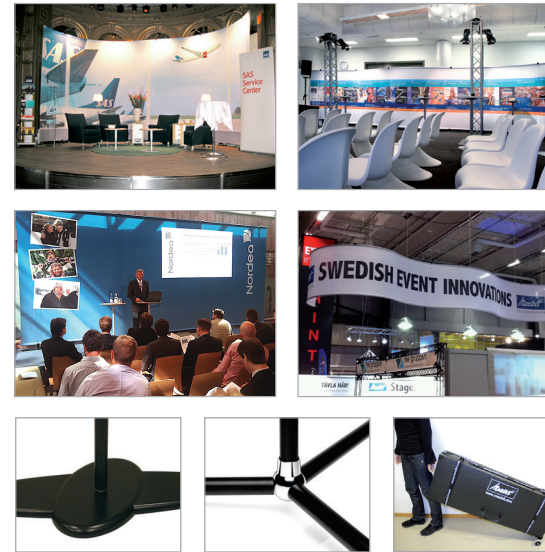

**Specifications: Stage Modular**

**PARTS AVAILABLE**

- Complete pole kits (Oval or tripod foot)
- Vertical extension poles (110 cm)
- Horizontal profile 2 pack (110 cm): Straight, 90, 45, 30, 15 degrees
- Horizontal profile 2 pack (45.5 cm): 90 degrees
- Holders and hangers, Bags, Light

**CONNECTORS**

All horizontal poles can be inserted into each other and are held tight by magnets. Vertical poles screw together.

**POLE HEIGHT**

Customisable height: All poles come in a standard height of 2,25 cm. Can be extended in lots of 1.10 meters

**WIDTH**

Customisable width. Build as long as you want. Starting at 1.10 meters and extendible in width in lots of 1.10 meters

**Footprints**

Also available for download <http://www.maxibit.com/download/>

Diagram illustrating various Stage Modular footprint configurations and dimensions:

- Stage Poles:**
  - Straight: 110cm 43,3"
  - 15°: 110cm 43,3"
  - 30°: 110cm 43,3"
  - 45°: 107cm 42"
  - 90°: 100,5cm 39,5"
  - 90° short: 38,5cm 15"
- Stage Poles (Curved/S-shaped):**
  - Curved 3: 323cm 127,2"
  - Curved 3: 300cm 118,1"
  - Curved 3: 266cm 102,4"
  - S-shaped 4: 157 435cm 171,2"
  - S-shaped 4: 307 420cm 165,4"
  - S-shaped 4: 457 394cm 156"
- Stage Poles (Straight and Curved):**
  - Straight 2 and curved 2 45°: 430cm 169,3"
- Stage Feet:**
  - Stage Tripod foot: 40,1cm 15,8"
  - Stage Oval foot: 80,8cm 31,8"
  - Stage Oval foot: 27cm 10,6"
- Booth Configurations:**
  - Booth 3x3m 9'8" x 9'8"
  - Booth 7x3,5m 23'11" x 11'5"
  - Booth 6x4m 19'7" x 13'1"
  - Booth 3x3m 9'8" x 9'8"
  - Booth 6x2m 19'7" x 6'5"
  - Booth 6x2m 19'7" x 6'5"

**How big do you want it?**

Stage Modular is the perfect solution for you who wants to build large marketing surfaces on your own terms. Stage Modular is a selection of loose Stage parts that allows you to quickly assemble a Stage backdrop or hanging creation in any number of shapes, sizes and curves. Stage Modular allows you to build in terms of height, width and various curvatures. Heavy duty hangers allow you to hang everything from the ceiling.

**Why choose Stage Modular:**

- Stage Modular is perfect for those with Stage experience that want a great custom effect
- Perfect for spaces that aren't conventional
- Ideal for large spaces such as scenes and convention halls
- Great for creating your own marketing space tailored to your brand



Maxibit has been a member of UN Global Compact since 2007, [www.unglobalcompact.com](http://www.unglobalcompact.com).

# Scene UltraLight, Flexible fabrics



## Specifications: Scene UltraLight

### CONSTRUCTION

Alloyed aluminium profiles.

### VARIATIONS:

Straight, curved or Bit'a'Both (curved and straight)

### GRAPHIC MATERIAL:

Textile graphics

### WIDTH:

3 meters

### HEIGHT:

Backdrop/Bannerstand: 2.25 meters

### WEIGHT:

9 kg  
(weight is complete with case and graphic)

## Footprints

### Example of variations

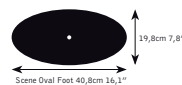
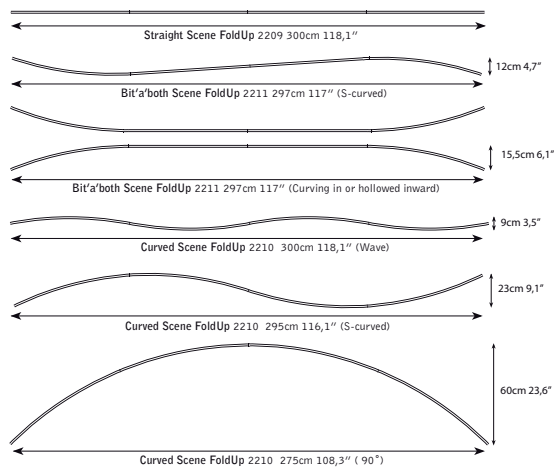

## What is Scene UltraLight?

Scene UltraLight is a selection of innovative stretch fabric displays that are light and mobile. Making your next event stressfree, Scene UltraLight's backdrop uses the latest in fabric print to give you a flexible display that can be transported easy. Set up in minutes, you can have a curved, straight or Bit'a'Both backdrop that perfectly frames your booth. Scene UltraLight is available in ready-to-deploy kits!

Ready, steady, go!

## Why choose Scene UltraLight:

- Light weight and impressive size (3 x 2,25 meters)
- Easy to transport and simple to setup
- Ready-to-deploy kits that are perfect for public events, mobile campaigns and taste-testings
- Flexible shapes with the latest technology

Website



YouTube setup manual



Maxibit has been a member of UN Global Compact since 2007, [www.unglobalcompact.com](http://www.unglobalcompact.com).



[www.maxibit.com](http://www.maxibit.com)

# Scene Modular, Customised fabrics



**Specifications: Scene Modular**

**PARTS AVAILABLE:**

- Foot with pole (tripod and oval)
- Straight horizontal poles (2 pack): 50, 75, 100 cm
- Straight horizontal poles (50 pack): 50, 75, 100 cm
- Hanger clips (2-pack)
- Bag for 50 and 75 cm poles and foot
- Bag for 100 cm poles and foot
- I-lite

**CONNECTORS:** All horizontal poles can be screwed to together

**POLE HEIGHT:** Pole is extendable from 88 to 225 cm

**WIDTH:** Customisable width. Build as long as you want. Starting at 50 cm and available in increments of 25 cm.

**Footprints**

Scene Tripod Foot 59cm 23,2"  
Scene Oval Foot 40,8cm 16,1"

Note: Ideally poles are to be placed every 2 meters

**Standard**

50cm 19,7"

**Example of variations**

100cm 39,4"  
50cm 19,7" 100cm 39,4" 75cm 29,5"  
75cm 29,5"  
75cm 29,5" 75cm 29,5" 75cm 29,5"  
100cm 39,4" 50cm 19,7" 50cm 19,7" 100cm 39,4" 100cm 39,4"

**What is Scene Modular?**

Scene Modular is a selection of parts that enables you to build custom scene banners in increments of 25 cm widths. Starting at 50 cm, you can build as wide as you like. All horizontal poles screw quickly together giving you flexibility to change the size of your booth when you need to. Scene Modular can also be deployed as a hanging solution in the width and height of your choice.

**Why choose Scene Modular:**

- Customised to your unique need
- Build light weight flexible banners that are easy to transport
- Perfect for smaller public events, taste-testings and career days
- Hang from the ceiling
- Make backdrops or bannerstands



# Performance, a new Pop-up system



**Specifications: Performance**

**CONSTRUCTION**  
Aluminum profiles with folding magnetic channel bars

**VARIATIONS:**  
Straight and Curved

**GRAPHIC MATERIAL:**  
Laminated paper or digital transparencies, matte or glossy.

**WIDTH:**  
Curved: from 125 cm up to 405 cm  
Straight: from 129 cm up to 430 cm

**HEIGHT:**  
230 cm

**WEIGHT:**  
3x3 section: 15 kg including graphic

**Footprints**

<p>1250 mm 49.2"</p> <p>350 mm 13.8"</p>	<p>1290 mm 50.8"</p> <p>310 mm 12.2"</p>
<p>2030 mm 79.9"</p> <p>520 mm 20.5"</p>	<p>2050 mm 80.7"</p>
<p>2700 mm 106.3"</p> <p>560 mm 22"</p>	<p>2800 mm 110.2"</p>
<p>3370 mm 132.7"</p> <p>720 mm 28.3"</p>	<p>3550 mm 139.8"</p>
<p>4050 mm 159.4"</p> <p>1000 mm 39.4"</p> <p>Height 2300 mm 90 1/4"</p>	<p>4300 mm 169.3"</p> <p>Height 2300 mm 90 1/4"</p>

**What is Performance?**

Performance is a compact and versatile pop-up system that is quick to set up at any location. The folding magnetic channel bars makes the assemble super easy. Performance is available in straight or curved in a number of widths, from 125 cm up to 430 cm. Choose double or single sided configurations to meet any space requirement.

**Why choose Performance:**

- Quick to set up and easy to mount graphic
- Continuous seamless graphic
- Folding magnetic channel bars
- Clean design with a professional look
- Single or double sided

# Network & NW Frost, Pop-up system



## Specifications: Network & NW Frost

### VERSIONS

Straight, Curved, S-shaped, Square Edge, custom heights.

### CONSTRUCTION

Aluminium pop-up system. The system, graphics, lights extension cord and accessories are transported in the All-in-One Podium.

### GRAPHIC MATERIAL

Laminated paper or digital transparencies, matte or glossy.

### GRAPHIC SIZE

Front panel: 68x223.5 cm. Side panel: 66x223.5 cm.  
 SquareEdge: 30.1x223.5 cm. Back panel: 80x223.5 cm.  
 Straight panel: 73.3x223.5 cm.  
 Display counter (All-in-One): 163x85 cm.

### WIDTH

Four sections = 320 cm.

### HEIGHT

Three sections = 225 cm.

### DEPTH

Each section is about 30 cm deep.

### WEIGHT

4x3 sections = 33 kg incl. graphics, lights and display counter.

**Footprints**

- Network curved 3x3: 225 cm height, 220 cm width
- Network curved 4x3: 85 cm height, 310 cm width
- Network straight 3x3/4x3: 30 cm height, 220 cm and 345 cm widths
- S-shaped Network 6x3: 30 cm height, 450 cm width
- Network round 15x3: 440 cm diameter

**Ideas**

**Seamless graphic precision**

Network is a very compact and versatile pop-up system that is quick to set up at any location. It allows you to meet your customers where they are, rather than having them come to you. Network can be designed in a number of different shapes; straight, curved, wave-shaped, stair formations, double or single sided and many more.

With Network Frost, you can turn the standard display system into a refined shelving system for a walk around experience of your displayed products.

**Why choose a Network**

- Unlimited layout options
- Continuous seamless graphics
- Quick to set up and easy to mount graphics
- Stable design with a professional look
- Adjustable feet for uneven floor
- Create showcases with Network Frost™ shelves



# Maxibit LaunchPack

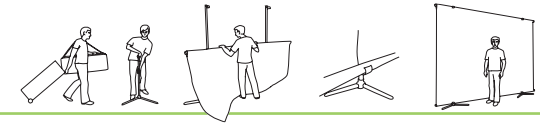

### Maxibit Scene

- Quick set up and easy graphic exchange
- Use hanging or free-standing
- Custom length when used hanging
- 0-360 degrees with Scene Link™
- Create any architectural design



**Specifications: LaunchPack**

**VERSIONS**  
LaunchPack, CookPack; Sound-Pack, ShowPack

**MATERIAL**  
100% recycled plastic, Aluminum, rubber

**SIZE (LxWxH)**  
Desk size: 101x61x103 cm  
Case size: 101 x61 27 cm

**WEIGHT**  
17 kg

### Footprints

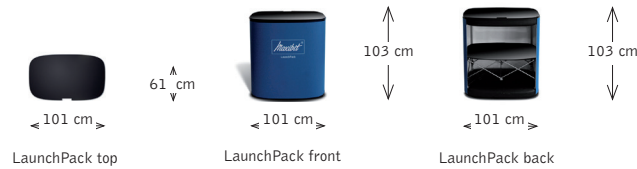

### Variations



**Point-of-Sale Perfection**

LaunchPack is everyone's Point-of-Sales dream. With its hollow insides you can transport the very best of Maxibit's designer P.O.S booths. The casing is made of 100% recycled plastic and has room for among other things, literature and sample products. It's streamline design allows it to be taken anywhere.

**Why LaunchPack**

- All-in-one desk and transport case with inner-shelf
- Unique suitcase design for easy transportation
- Perfect Point-of- Sales with stove, music and display case variations
- Hollow transportation shells can transport products, displays etc



# All-in-One Case



**Specifications: All-in-One Case**

**DESCRIPTION**  
A durable transportation box that can be turned into a counter.

**SIZE**  
Podium size:  
100x74x49 cm  
Double Podium size:  
100x176x66 cm  
Case size:  
99x59x43 cm

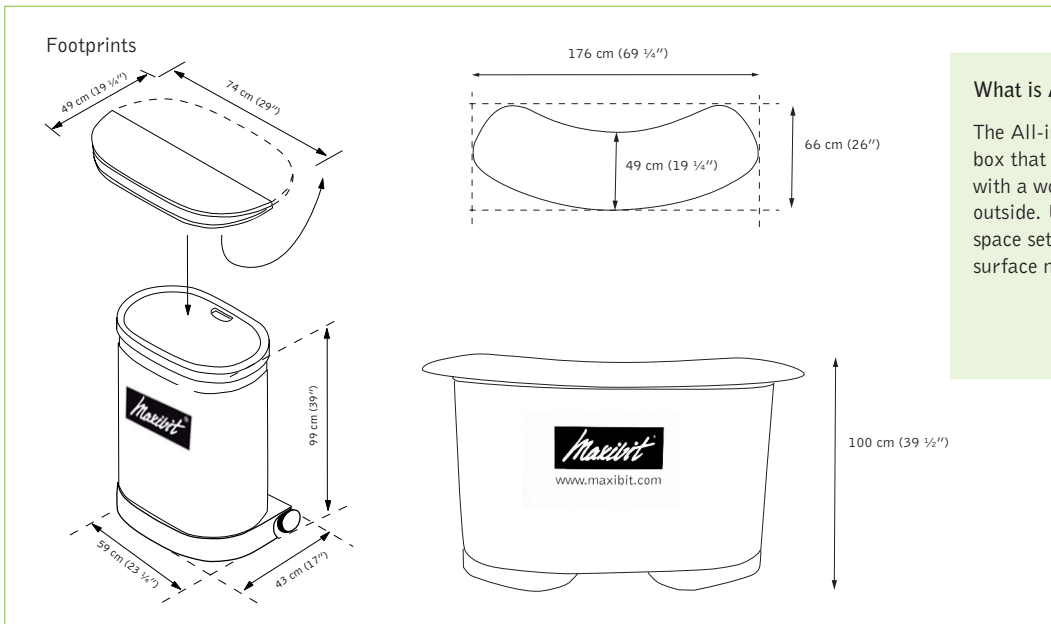

**What is All-in-One?**

The All-in-One Case is a durable transportation box that easily can be turned into a counter with a wooden top and a graphic wrap on the outside. Use a single All-in-One Case for small space settings or a double All-in-One for larger surface needs.

**Why choose All-in-One?**

- Built-in wheels and carry handle for easy handling
- Wooden folding top in black with exclusive brass hinges
- Graphic display area
- All-in-One is perfect for transportation of Performance, banner stands and Scene UltraLight



# Strengthen your brand with Zap D2 and Zap D3



**Specifications: Zap**

**VERSIONS**  
 Zap D2 (850), Zap D2 (1185)  
 Zap D3 (850), Zap D3 (1185)

**DESCRIPTION**  
 Aluminum alloy Roll-up with telescopic pole, Gripper profile and fast cassette-loading graphics. Flight Bag with pocket for spotlight.

**GRAPHIC MATERIAL**  
 All common materials, e.g. polyester.

**WIDTH**  
 850 mm and 1185 mm.

**HEIGHT**  
 Standard 2250 mm (adjustable, 900–3000 mm).

**WEIGHT**  
 Approx. 4 kg with graphics and flight bag.

**Footprints**

Adjustable up to 225 cm

85 cm      118 cm      85 cm

**Ideas**

**What's your best choice of roll-up?**

There is a significant difference between Zap and other roll-ups. With Zap D2 and D3, you can be assured that your message is delivered with the strongest impact and the highest quality. Zap comes in two designs. D2 is the most compact while D3 has no visible, protruding foot on the floor. Zap is 100% recyclable for a better environment. With Zap D2 and D3 you will always be prepared – meet your customer whenever, wherever. When it's time for your next campaign, you can change your message in less than a minute without the need for tools.

**Why should I choose Zap**

- Clever Gripper profile
- Fast and easy graphics exchange
- Adjustable with a quality Swedish design
- 2 designs and 2 widths; 4 versions
- Generous graphic dimensions
- Adjustable height, 900–3000 mm
- Drop-in pole cup for easy set-up
- Excellent for the environment; re-usable and recyclable
- Accessories: Spotlight, brochure holder, presentation desk

Website

Maxibit has been a member of UN Global Compact since 2007, [www.unglobalcompact.com](http://www.unglobalcompact.com).

[www.maxibit.com](http://www.maxibit.com)

# Solo Banner Stand

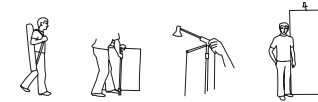

### Maxibit Solo 1

- Compact design for cost effective distribution
- Quick to set up and to change graphics
- Adjustable height 88-225 cm
- Single or double sided
- Lightweight for easy transport



### Maxibit Solo 3

- Quick to set up and to change graphics
- Adjustable height 88-225 cm
- Single or double sided
- Compact design for cost effective distribution
- Lightweight for easy transport



Solo 1



Solo 3



**Specifications: Solo**

**VERSIONS**  
 Solo 1 850/610 mm  
 Solo 3 850/610 mm

**DESCRIPTION**  
 Aluminum alloy banner stand with telescopic pole. Re-usable Gripper profiles for snap-in graphics. Flight Bag with pocket for spotlight.

**GRAPHIC MATERIAL**  
 All common materials, e.g. polyester.

**WIDTH**  
 850/610 mm.

**HEIGHT**  
 Adjustable up to 225 cm.

**WEIGHT**  
 1.2 kg excl. graphics and flight bag.

## Footprints

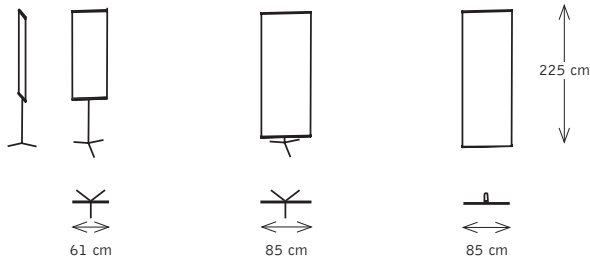

## Ideas

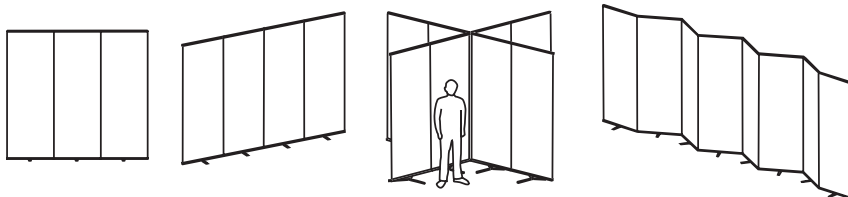

**What's your best choice of banner stand?**

Solo is ultra-compact, yet fully equipped like no other. The Solo 1 and Solo 3 banner stands have unique, clever features for your successful campaigns. Solo 1 has no visible foot on the floor. Solo 3 has an elegant, fold-out tripod foot. The telescopic pole and a bottom slider give height to be adjusted to fit your preferences. Solo can be seamlessly connected side by side, straight or at an angle, thanks to built-in power-magnets. Clever Gripper profiles allow for fast and easy graphics exchange without tools or tape. Solo is 100% re-usable and recyclable, kind to the environment.

**Why should I choose Solo**

- Clever Gripper profiles for the easiest graphics exchange
- Ultra-compact for smart carrying
- Adjustable height, top profile 1000–2250 mm, bottom profile 0–750mm
- 2 designs, 2 widths, 4 versions
- Multiple Solos side by side create impressive larger backdrops
- Built-in power-magnets allow for straight or angled lineup
- Accessories: Spotlight, brochure-holder, presentation desk

Website



Maxibit has been a member of UN Global Compact since 2007, [www.unglobalcompact.com](http://www.unglobalcompact.com).



[www.maxibit.com](http://www.maxibit.com)

# Beach Flag



**Specifications: Beach Flag**

**DESCRIPTION**  
Portable outdoor solution.

**HEIGHT**  
Three different heights:  
2.5 m  
3.4 m  
4.7 m

**WEIGHT**  
Weight starts at 1.8 kg incl. carry bag



**What is Beach Flag?**

Maxibit's BeachFlags are the ideal advertising solution when it comes to outdoor events. Setting up the Beach Flag is easy thanks to our range of custom bases for snow, beach, grass or concrete. The flag is available in 3 different sizes, to ensure the best solution for displaying your company logo or message.

**Why choose a Beach Flag:**

- Creates high visual impact
- Easy to transport and set up in any desired environment
- The rounded corner design ensures that the fabric is stretched tight and the pole stays straight.
- All Beach Flags come complete with a carry bag
- 100% recyclable material for a better environment

Maxibit – the greener choice™

Maxibit has been a member of UN Global Compact since 2007, [www.unglobalcompact.com](http://www.unglobalcompact.com).



[www.maxibit.com](http://www.maxibit.com)

# Eagle, Brochure Stand



**Specifications: Eagle**

**DESCRIPTION**  
Portable brochure stand with 4 brochure holders.

**SIZE STANDING**  
L27 x W24.5 x H156 cm.

**SIZE PACKED DOWN**  
L27 x W24.5 x H40 cm.

**POCKET SIZE INTERIOR**  
21.6 cm x 33 cm, suitable for A4 brochures.

**WEIGHT**  
4.2 kg.

**Footprint**

Height 156 cm

24.5 cm

27 cm

Easy to bring every where

Sturdy nylon bag

Travels with the brochures

**Long-lasting and user-friendly**

Eagle has been engineered to be the perfect compliment to any marketing display. Its timeless design and quick set up means that it can be deployed any time and anywhere. Its small foot-print and low centre of gravity allows it to be placed in the most crowded areas but for maximum impact the system is best used in tandem with other products in the Maxibit range. For the campaign trail, use Eagle with Maxibit Zap for a subtle yet powerful shopping mall display, while at the trade fair, several Eagle used side by side can add elegance to your booth.

**Why choose a Eagle**

- Quick to set up with auto-locking mechanism
- Works in any environment
- Comes in two different colours
- One of the lightest brochure holders available
- Brochures can be transported safe in the stand
- Delivered in handy nylon carrying bag



# iPad Stand



**Specifications: iPad Stand**

**DESCRIPTION**  
Lightweight lockable stand for your iPad tablet.

**WIDTH**  
49.5 cm

**HEIGHT**  
117 cm

**WEIGHT**  
2 kg

Footprint

Height 117 cm (46")

49.5 cm (49")

**What is iPad Stand?**

The iPad Stand is a lightweight lockable stand for your iPad tablet. It's a versatile and functional stand that can be used with iPad 2, iPad 3 and iPad 4 in any environment. The angle can be adjusted and the iPad can be displayed in both landscape and portrait orientation. The sturdy tripod foot ensures total stability.

**Why choose a iPad Stand?**

- Quick to set up and easy to carry
- Works in any indoor environment
- Rotates 360° for portrait or landscape orientation
- Lockable holder to secure your iPad tablet

# Stage Table



Specifications: Stage Table	
<b>DESCRIPTION</b>	A portable bar height cafe table
<b>WIDTH</b>	49.5 cm
<b>HEIGHT</b>	96 cm
<b>WEIGHT</b>	8 kg

Footprint

49.5 cm (49")

Height 96 cm (37 3/4)

**What is Stage Table?**

The Stage Table is a modern version of a bar height cafe table that is collapsible, light to carry and easy to set up. The table is a perfect meeting point at any event. Use a single table or in a group, together with a backdrop wall or on its own.

**Why choose a iPad Stand?**

- Intuitive and easy set up
- Large base for maximum stability
- Completely collapsible and portable
- Delivered in two nylon carry bags